

SECTION CD

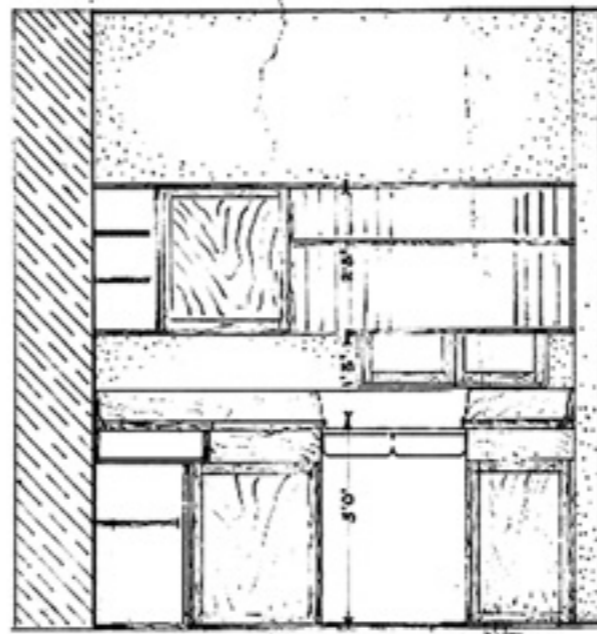

SECTION GH

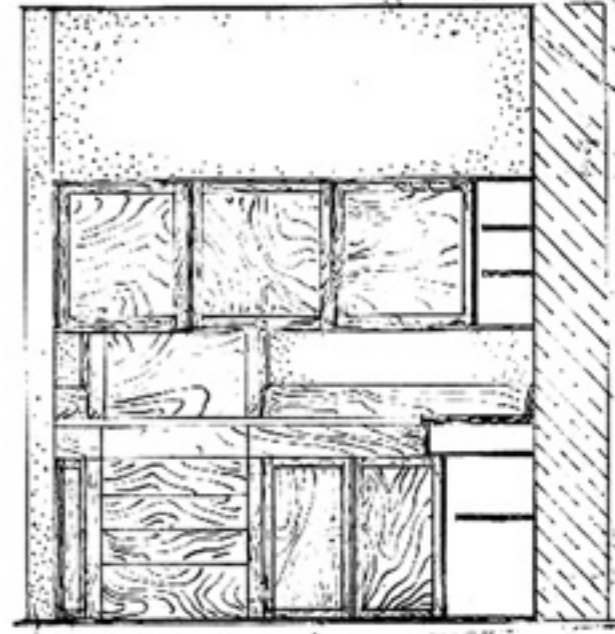

SECTION HG

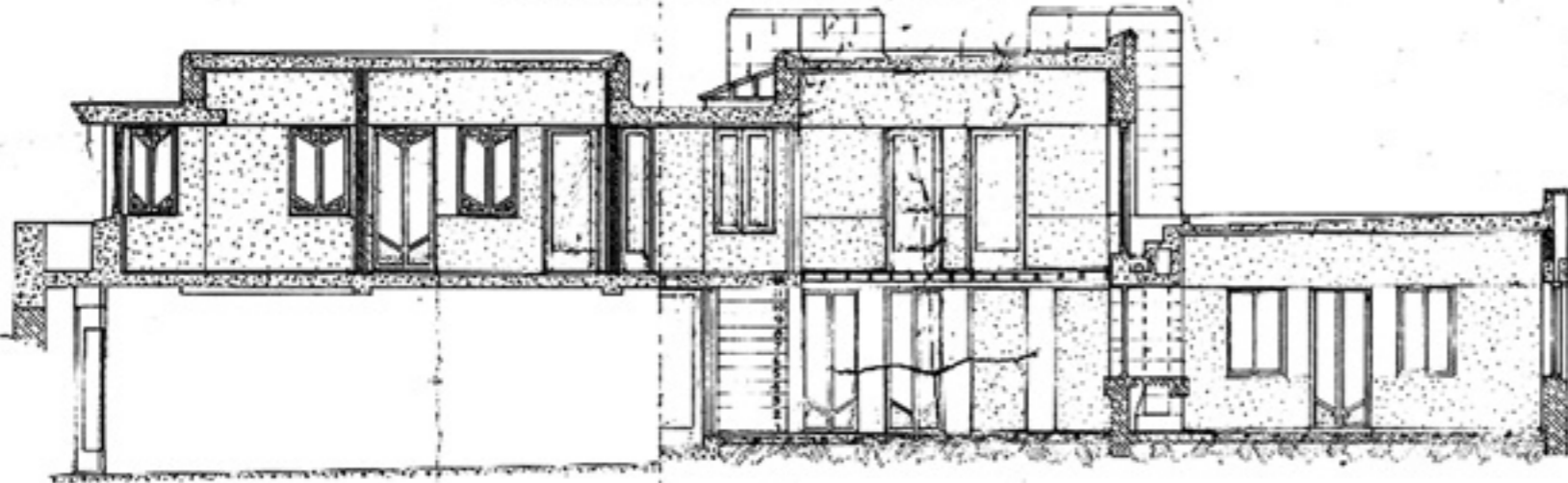

SECTION AD

ELEVATIONS OF
KITCHEN DETAILS
SCALE 1/4" = 1'

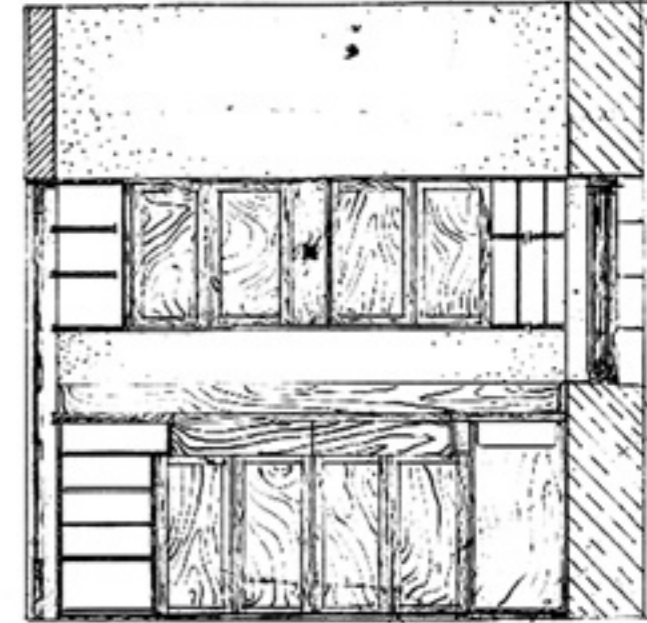

SECTION FE

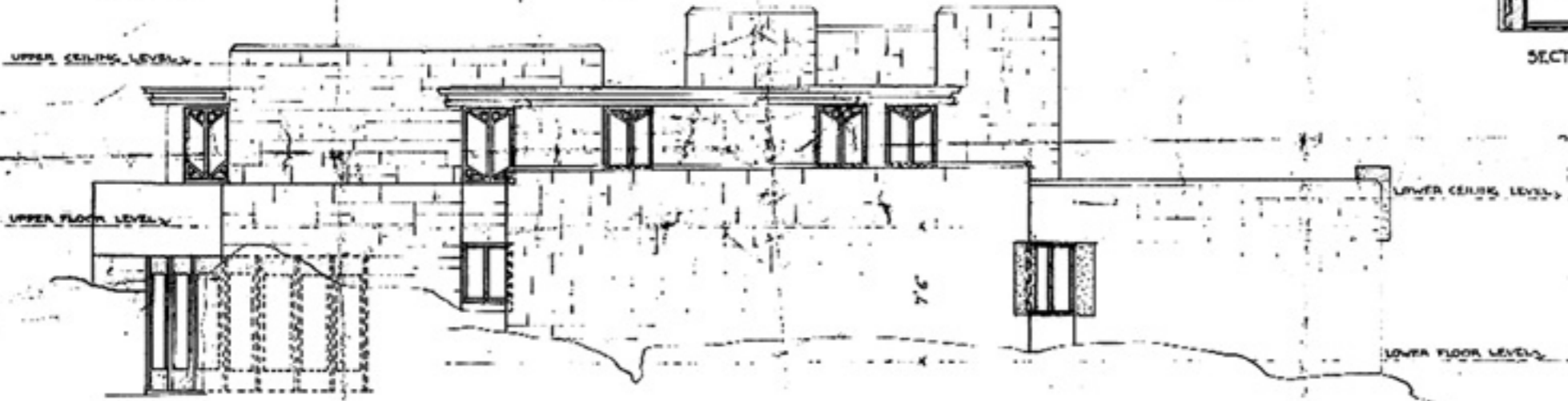

SOUTH ELEVATION

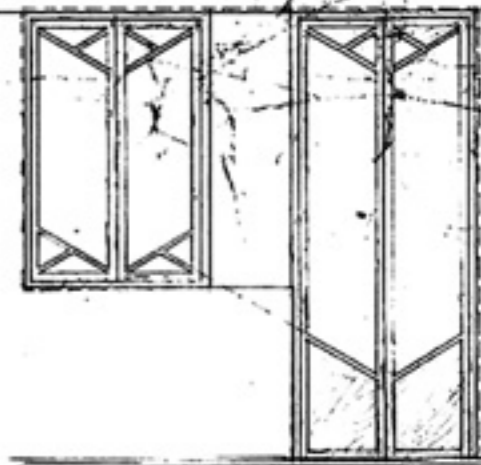

WINDOW SCALE 1/4" = 10" GLASS DOOR

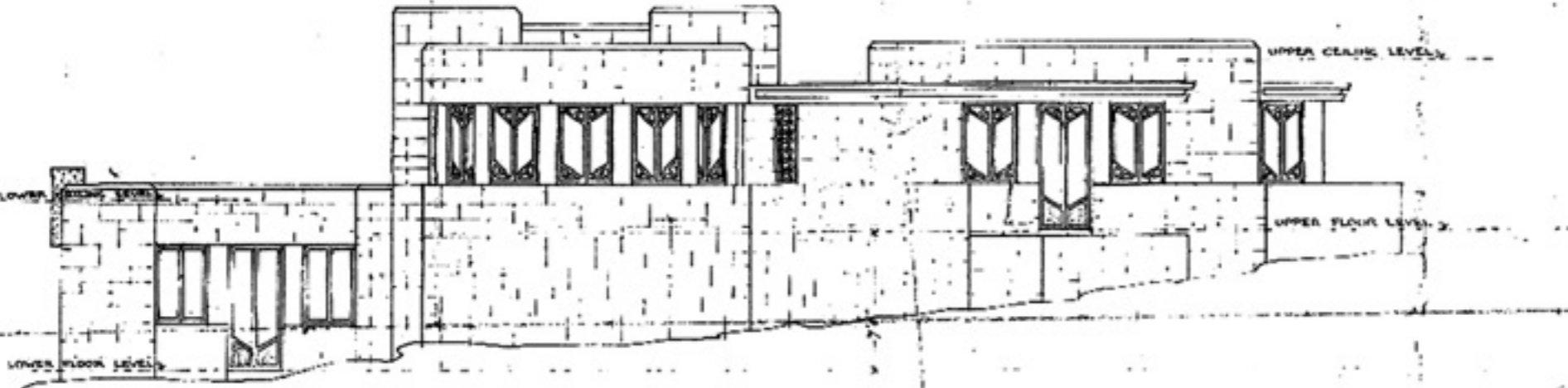

NORTH ELEVATION

MR. THOMAS W. FISHWICK
DWELLING 331 THE CITADEL
CASTLECRAG WILLOUGHBY
WALTER B. GRIFFIN ARCHITECT
SCALE 1/4" = 10" 6 JULY 1929

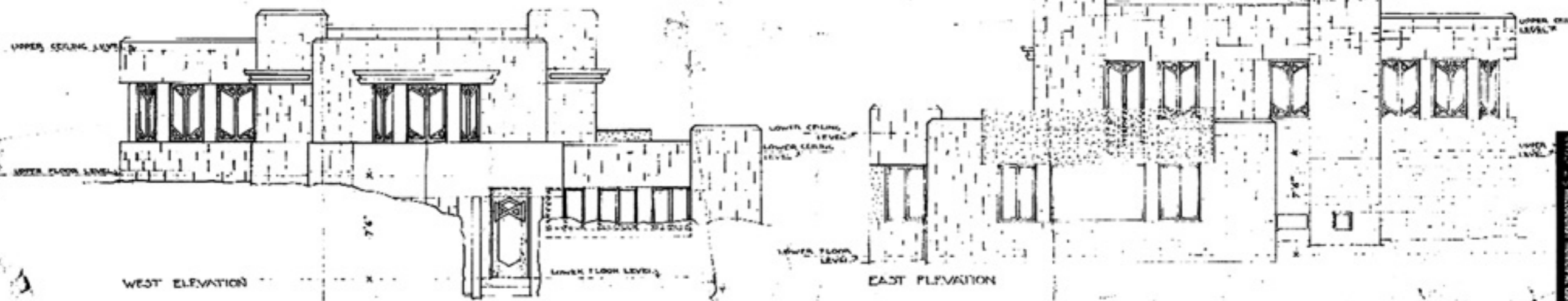

WEST ELEVATION

EAST ELEVATION